

1. FUNCTION: OFF-ON
OFF-ON
2. RATING: UL: 12(6)A 125/250VAC 25T125 5E4
ENEC VDE/CQC: 8/108A 250V~ μ T105 12(4)A 250V~ μ T105
TUV/CE: 8/128A 250V~ T105
KC: 12(4)A 250V~ T105
3. OPERATION FORCE: 700±300g.f
4. CONTACT RESISTANCE: ≤ 50 mΩ
5. INSULATION RESISTANCE: ≥ 100 MΩ
6. DIELECTRIC WITHSTAND : TERMINAL TO BUTTON 3000VAC/5mA/1MINUTE
TERMINAL TO TERMINAL 1500VAC/5mA/1MINUTE
7. CIRCUIT DIAGRAM:

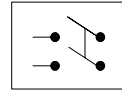

8. SUGGESTED PANEL HOLE SIZE:

PANEL THICKNESS	DIM.X
0.75-1.25	19.2/19.1
1.25-2.0	19.4/19.3
2.0-3.0	19.8/19.7

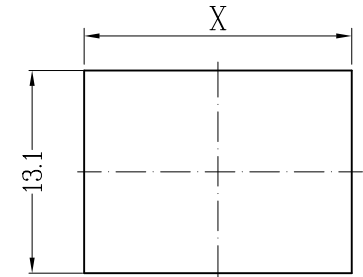

PANEL CUT-OUT

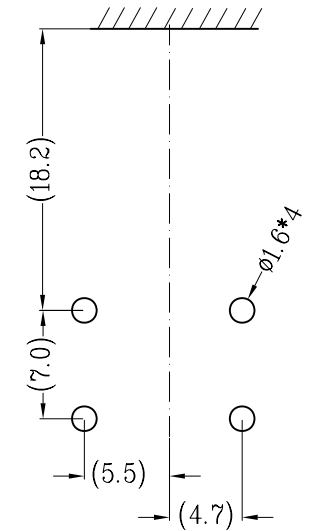
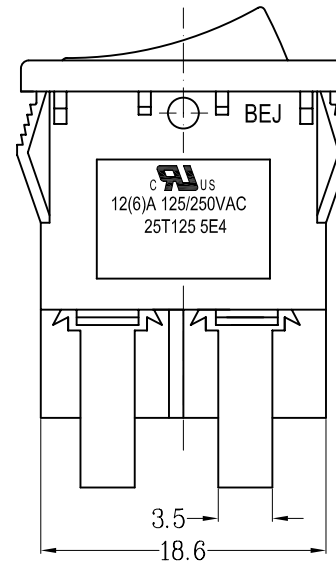
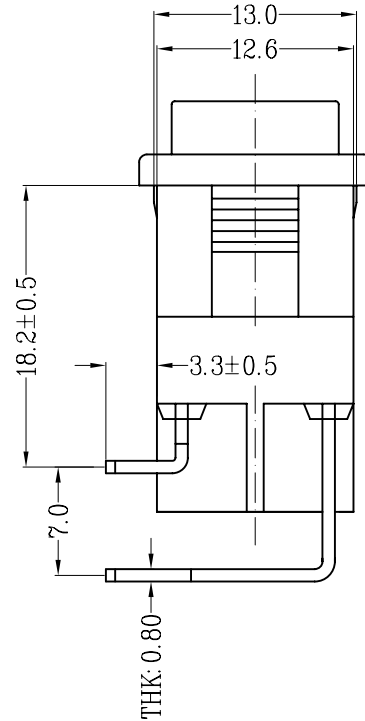
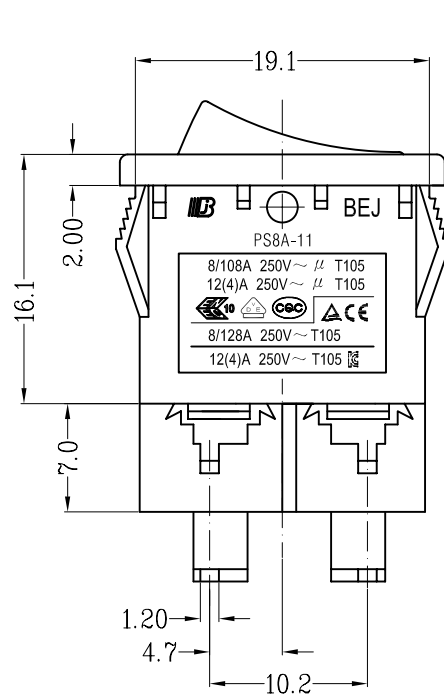

TOLERANCE UNLESS SPECIFIED					
.X: ±0.30		: ±0.15 ANGULAR ±3.0°			
PROJECTION		V1.0			
		ISSUE	DATE	DESCRIPTIONS OF REVISION	APPD.
TITLE: ROCKER SWITCH	UNIT: mm	SCALE: NOT SCALE	DRWG NO.: BEJ-FH-W0130		
MODEL: PS8A-11-B1B4-5A-28	FUNCTION: OFF-ON OFF-ON		DWN.	吴为萍	2014-07-16
东莞市涪程电子科技有限公司			CHK'D.	冯辉	2014-07-16
			APPD.	谭云锋	2014-07-16