

- 1、FUNCTION: 指示灯
- 2、RATING: UL: 250VAC 1/2HP 8A 250VAC 10A 125VAC  
CQC: 6A/12A 250VAC  
ENEC VDE: 12A 125VAC 6(4)A 250VAC  $\mu$  T105
- 3、OPERATION FORCE: 650 $\pm$ 350g.f
- 4、CONTACT RESISTANCE:  $\leq$  50 m $\Omega$
- 5、INSULATION RESISTANCE:  $\geq$  100 M $\Omega$
- 6、DIELECTRIC WITHSTAND:

TERMINAL TO BUTTON 3000VAC/5mA/1MIN/TUE  
TERMINAL TO TERMINAL 1500VAC/5mA/1MIN/TUE

7、CIRCUIT DIAGRAM:

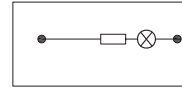

8、SUGGESTED PANEL HOLE SIZE:

PANEL THICKNESS	DIM.X
0.75-1.25	19.2/19.1
1.25-2.0	19.4/19.3
2.0-3.0	19.8/19.7

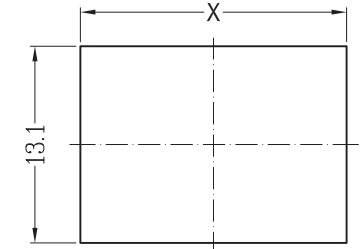

PANEL CUT-OUT

TOLERANCE UNLESS SPECIFIED					
.X: $\pm 0.30$ : $\pm 0.15$ ANGULAR: $\pm 3.0^\circ$					
PROJECTION:		V1.0			
	ISSUE	DATE	DESCRIPTIONS OF REVISION		APPD.
TITLE: ROCKER SWITCH	UNIT: mm	SCALE: NOT SCALE	DRWG NO.: BBEJ-FH-W0583		
MODEL: PS8A-13-B2G1-17H(A10979)	FUNCTION: 指示灯		DWN.	黄荟荟	2016-05-26
东莞市涪程电子科技有限公司			CHK'D.	冯辉	2016-05-26
			APPD.	谭云峰	2016-05-26