

- 1、FUNCTION: ON-ON
ON-ON
- 2、RATING: UL: 16A 250VAC 1/4HP 20A 125VAC 1/4HP 250VAC 3/4HP
ENEC VDE/CQC: 16(4)A 250VAC T105
- 3、OPERATION FORCE: 650±350gf
- 4、CONTACT RESISTANCE: ≤ 50 mΩ
- 5、INSULATION RESISTANCE: ≥ 100 MΩ
- 6、DIELECTRIC WITHSTAND : TERMINAL TO BUTTON 3000VAC/5mA/1MIN/TUE
TERMINAL TO TERMINAL 1500VAC/5mA/1MIN/TUE
- 7、CIRCUIT DIAGRAM:

8. SUGGESTED PANEL HOLE SIZE:

PANEL THICKNESS	DIM. X
0.75~1.25	30.1/30.0
1.25~2.0	30.3/30.2
2.0~3.0	30.6/30.5

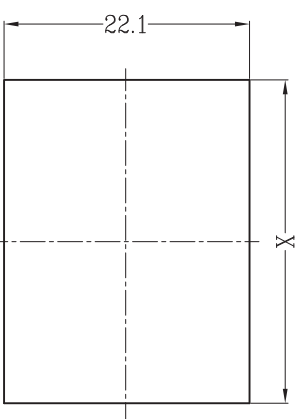

TOLERANCE UNLESS SPECIFIED					
.X:±0.30 .XX:±0.15 ANGULAR:±3.0°					
PROJECTION:	ISSUE	DATE	DESCRIPTIONS OF REVISION	APPD.	
TITLE: ROCKER SWITCH	UNIT: mm	SCALE: NOT SCALE	V3.0		
MODEL: PS8C-5-BIB3-12H-10	FUNCTION: ON-ON				

DRWG NO.:	BEJ-FH-W0494
DWN.	吴为萍
CHK'D.	冯辉
APPD.	谭云锋
	2015-11-16
	2015-11-16
	2015-11-16

东莞市浔程电子科技有限公司